

## Warewashing Small Single Skin Glasswasher, drain pump and detergent and rinse aid dispenser, 30b/h - UK plug

ITEM # \_\_\_\_\_

MODEL # \_\_\_\_\_

NAME # \_\_\_\_\_

SIS # \_\_\_\_\_

AIA # \_\_\_\_\_

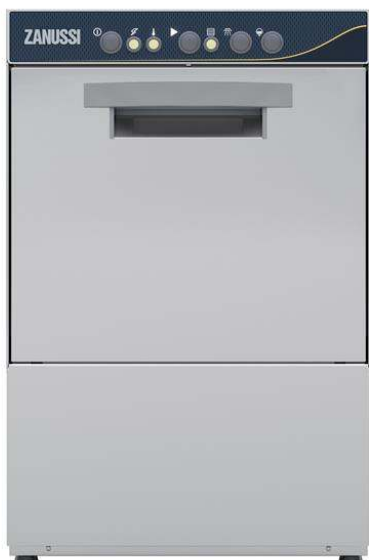

402296 (ZSGU)

Glasswasher (small), with single skin, built-in drain pump and detergent and rinse aid dispenser, 1 cycle, 30b/h - UK plug

### Short Form Specification

#### Item No.

Unit shall be Glasswasher type hot water rinsing using rack dimension of 400\*400mm. Electrical characteristics to be 230 volts single phase 50Hz operation with one wash cycle of 120 seconds. Washing performance is ensured by a powerful wash pump, revolving washing spray arms from both bottom and top. Rinse temperature and pressure guaranteed by built in pressure boiler. Double skinned counter-balance door. Large door opening of 290mm for washing tall glasses. Single skinned cabinet. Pressed tank with round corners. 304 stainless steel construction to include door, frame, wash arms and rinse arms. The unit shall include drain pump, detergent and rinse aid dispenser pumps and is equipped with electric cable with UK plug.

### Main Features

- Deep drawn pressed wash tank with fully rounded corners, sloped towards the drain to prevent dirt build up provides fast drainage in only a few minutes. Pressed wash tank with no welded points offer a guaranteed water tight solution.
- Maximum capacity of 30 racks per hour.
- Easy service access to main components without moving the unit.
- Built-in rinse aid and detergent dispenser with automatic initial and continuous cycle loading for perfect result while minimizing service and maintenance needs.
- Equipped with drain pump for easy and quick installation without opening the machine.
- 120 seconds cycle.
- Built-in pressure boiler designed to raise incoming water to a guaranteed minimum temperature of 82°C for sanitizing rinse. No external boiler is required.
- Equipped with single phase electrical cable and UK plug for easy and fast installation.
- Washing system endowed with rotating washing arms, high powered wash pump and large capacity wash tank for professional washing.

### Construction

- Internal components (arms and filter) are easy extractable.
- Completely closed on the back by a cover plate.
- Unit to feature rinse aid and detergent dispenser pumps.
- Robust structure thanks to stainless steel construction.

### Sustainability

- Finished in top quality materials to ensure durability.
- Simple operation control panel.
- Insulated double skin door construction preserves heat inside the tank to lower energy consumption and the noise. Counter-balance mechanism minimizes impact when opening and closing.

### Included Accessories

- 1 of Square basket for glasses 400x400x150mm PNC 864470
- 1 of Insert for 12 saucers, 290x90x75mm PNC 867048
- 1 of Square cutlery container, 89x113x113mm PNC 867049

### Optional Accessories

- Square basket for plates, 400x400x110mm PNC 867039 ☐
- Round basket for glasses, 400x180mm PNC 867047 ☐
- Inclination insert for glasses 400x400 mm PNC 867069 ☐
- Kit detergent dispenser for single skin XS and single skin S glasswasher PNC 867072 ☐

APPROVAL: \_\_\_\_\_

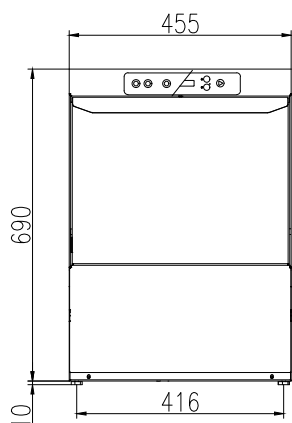
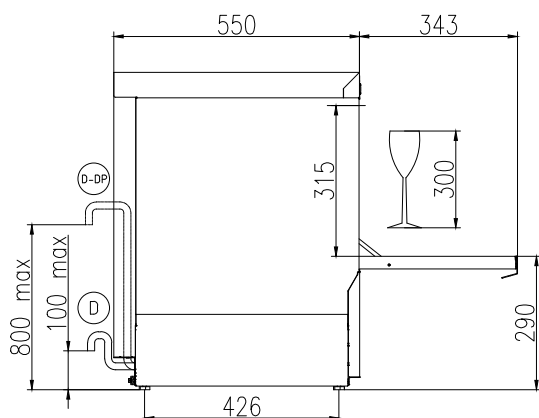
**Front**

**Side**

**CW11** = Cold Water inlet 1  
(cleaning)

**XR** = Rinse aid connection

**D** = Drain

**EI** = Electrical inlet (power)

**EO** = Electrical Outlet

**WI** = Water inlet

**XD** = Detergent connection

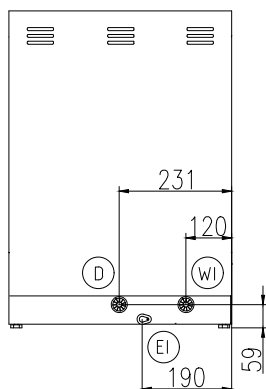
**Rear side**

## Electric

Supply voltage:

402296 (ZSGU) 220-240 V/1 ph/50 Hz

Default Installed Power: 2.7 kW

Boiler heating elements: 2.7 kW

Tank heating elements: 2.4 kW

Wash pump size: 0.2 kW

## Water:

Pressure, bar min/max: 2-5 bar

Drain line size: 29mm

Washing tank capacity (lt): 12

Boiler Capacity (lt): 3

Incoming water line size: 3/4"

## Key Information:

Baskets per hour\*: 30

Working cycles time (sec.): 120

Wash temperature: 60°C

Cell dimensions - width: 405 mm

Cell dimensions - depth: 437 mm

Cell dimensions - height: 315 mm

Rinse temperature: 85 °C

External dimensions, Width: 455 mm

External dimensions, Depth: 550 mm

External dimensions, Height: 700 mm

Net weight: 38 kg

Shipping weight: 42 kg

Shipping height: 850 mm

Shipping width: 540 mm

Shipping depth: 630 mm

Shipping volume: 0.29 m³

## Sustainability

Water supply temperature\*: 10-50 °C

Water consumption per cycle (lt): 2

Noise level: 61 dBA